

# FLANGE TYPE ROTARY TORQUE SENSORS

## Model TRE

Model TRE slipping rotating torque transducers have flange drives at both ends. This model is designed for the application with minimal space and high capacity requirement.

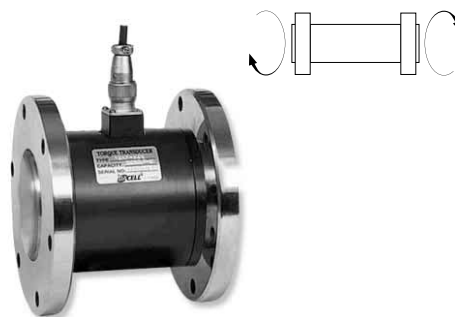

### Specifications

Specifications	Accuracy
Rated capacity	20kgf~5000kgf-m
Rated output	1.5mV/V
Nonlinearity	0.3%
Hysteresis	0.3%
Repeatability	0.3%
Terminal resistance, input	350 Ω ± 5 Ω
Terminal resistance, output	350 Ω ± 3 Ω
Insulation resistance	300 MΩ
Temperature range compensated	-10°C ~ 60°C
Temperature range safe	-20°C ~ 70°C
Temperature effect, on zero balance	0.08% R.O./10°C
Temperature effect, on rated output	0.08% Load/10°C
Excitation recommended	10V DC
Safe overload	150% R.C
Cable	φ 7 Shield 3m

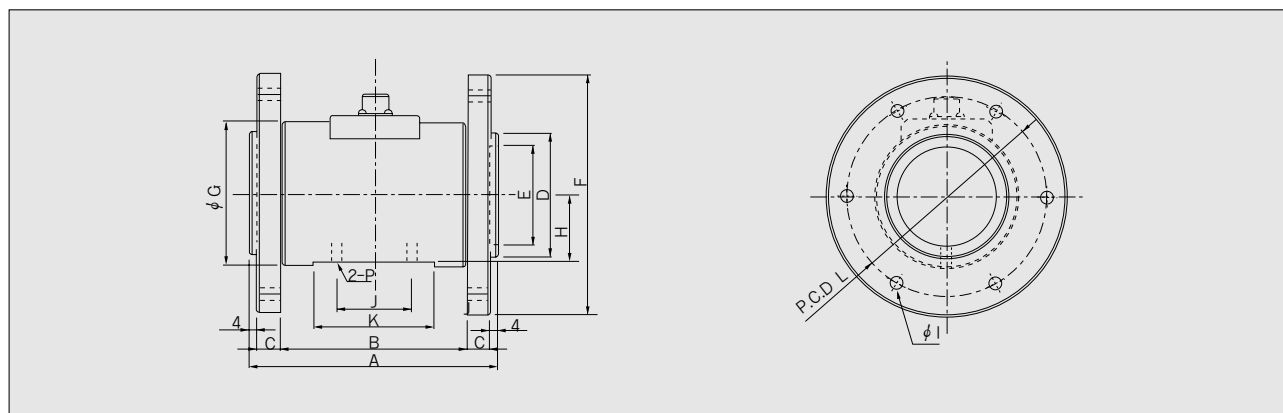

### Dimensions Table

Unit: mm

Capacity	A	B	C	φ D	φ E	φ F	φ G	H	I	J	K	L	P	RPM
20kgf-m(196.1N-m)	130	98	12	65	52	127	81	38	6-φ 6.5	40	64	105	M6 DP.8	5,000
50kgf-m(490.3N-m)	134	102	12	76	62	136	88	41.5	6-φ 8.5	40	64	114	M6 DP.8	4,000
100kgf-m(980.7N-m)	134	102	12	86	68	156	100	48	8-φ 10.5	48	64	130	M8 DP.8	4,000
200kg-m(196.1KN-m)	148	108	16	102	75	172	116	56	8-φ 10.5	50	68	146	M8 DP.8	3,000
300kgf-m(2.942KN-m)	148	108	16	102	75	172	116	56	8-φ 10.5	50	68	146	M8 DP.8	3,000
500kgf-m(4.903KN-m)	150	102	16	107	81	184	128	62	8-φ 10.5	56	74	158	M8 DP.8	3,000