

# SHAFT TYPE TORQUE SENSORS

## Model TRA

Model TRA load cell measure the torque of continuous rotating object. Platinum coated connector provides long term signal stability and high accuracy. These models are most appropriate for industrial measurement. Applications include the performance testers for automotive components such as clutches, transmissions, motors and pumps

※Option : r.p.m. sensor, Foot mount.

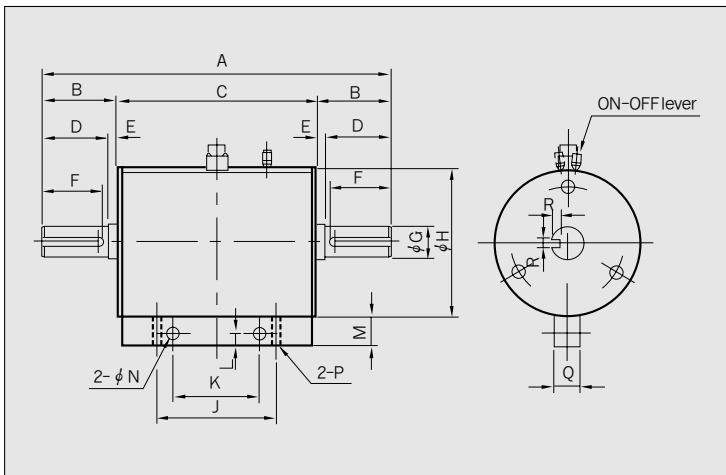
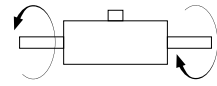

## Specifications

Specifications	
Rated capacity(R.C)	1~1000kgf-m
Rated output(R.O)	1.5mv/v±1%(1~5kgf-m:1mv/v)
Nonlinearity	0.3%R.O.
Hysteresis	0.2%R.O.
Repeatability	0.3%R.O.
Excitation recommended	10V
Terminal resistance	350Ω±1%
Insulation resistance bridge	200MΩ
Temperature effect, on rated output	0.3% R.O/10°C
Temperature effect, on zero balance	0.2% Load/10°C
Safe overload	120% R.C
Cable length	φ 7.4core cable 3m

## Dimensions Table

Unit:mm

Model (MM)	Rated Capacity	A	B	C	D	E	F	φ G	φ H	J	K	L	M	N	P	Q	R
TRA-1K	1kgf-m(9.807N-m)	203	43	117	38	5	35	18	85	70	50	7	17	7	M6	15	5×5
TRA-2K	2gf-m(19.61N-m)	203	43	117	38	5	35	18	85	70	50	7	17	7	M6	15	5×5
TRA-5K	5gf-m(49.03N-m)	203	43	117	38	5	35	18	85	70	50	7	17	7	M6	15	5×5
TRA-10K	10gf-m(98.07N-m)	240	55	130	50	5	45	32	100	90	50	7	17	7	M6	15	10×8
TRA-20K	20gf-m(196.1N-m)	240	55	130	50	5	45	32	100	90	50	7	17	7	M6	15	10×8
TRA-50K	50gf-m(490.3N-m)	340	95	150	90	5	85	47	118	100	60	8	20	9	M8	17	12×8
TRA-100K	100gf-m(980.7N-m)	340	95	150	90	5	85	47	118	100	60	8	20	9	M8	17	12×8
TRA-200K	200gf-m(1.961KN-m)	360	106	148	100	6	95	63	135	100	60	8	20	9	M8	17	18×11
TRA-300K	300gf-m(2.942KN-m)	360	106	148	100	6	95	63	135	100	60	8	20	9	M8	17	18×11