

# NON-ROTARY TORQUE SENSORS

## > Model TCN16

A static torque sensor for measurement of torque of stationary objects or within a certain angle rotation. Suitable for torque measurement of various automobile parts, pneumatic and electric screwdriver etc.

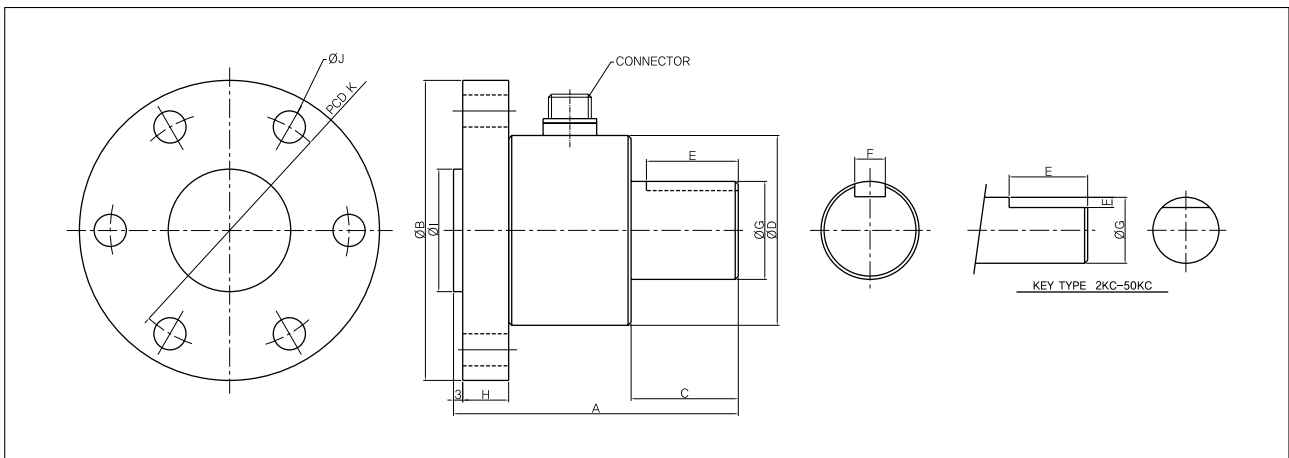
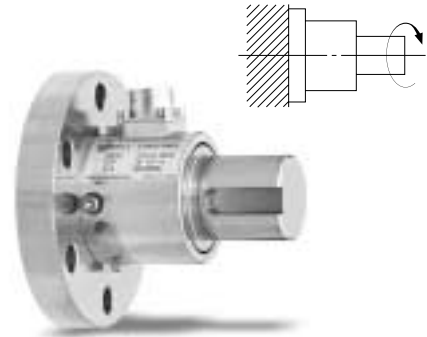

## > SPECIFICATIONS

Specifications	Accuracy
Rated capacity(R.C)	2kgf-cm~100kgf-cm(0.196N-m~490.3N-m)
Rated output(R.O)	1.5mv/v±1%(2kgf-cm~5kgf-m : 1mv/v)
Nonlinearity	0.3% of R.O.
Hysteresis	0.2% of R.O.
Repeatability	0.1% of R.O.
Excitation recommended	10V DC
Temperature range, compensated	0.3% R.O./10°C
Temperature range, safe	0.2% LOAD/10°C
Safe overload	120% R.O

## > DIMENSIONS TABLE

unit:mm

Capacity	A	B	C	D	E	F	G	H	I	J	K
2kgf-cm(0.196N-m)	63	58	20	34	15	1	8	5	20	4-Ø 4.5	46
5kgf-cm(0.490N-m)	63	58	20	34	15	1	8	5	20	4-Ø 4.5	46
10kgf-cm(0.981N-m)	63	58	20	34	15	1	8	5	20	4-Ø 4.5	46
20kgf-cm(1.961N-m)	63	58	20	34	15	1	8	5	20	4-Ø 4.5	46
30kgf-cm(2.942N-m)	68	80	20	34	15	1	12	10	40	4-Ø 6.5	66
50kgf-cm(4.903N-m)	68	80	20	34	15	1	12	10	40	4-Ø 6.5	66
1kgf-m(9.807N-m)	74	80	21	43	16	5×5	18	10	40	4-Ø 6.5	66
2kgf-m(19.61N-m)	74	80	21	43	16	5×5	18	10	40	4-Ø 6.5	66
3kgf-m(29.42N-m)	74	80	21	43	16	5×5	18	10	40	4-Ø 6.5	66
5kgf-m(49.03N-m)	74	80	21	43	16	5×5	18	10	40	4-Ø 6.5	66
10kgf-m(98.07N-m)	93	98	35	50	30	10×8	32	15	40	4-Ø 10.5	78
20kgf-m(196.1N-m)	93	98	35	50	30	10×8	32	15	40	4-Ø 10.5	78
50kgf-m(490.3N-m)	123	146	55	84	50	12×8	47	20	60	4-Ø 13	115
100kgf-m(980N-m)	123	146	55	84	50	12×8	47	20	60	4-Ø 13	115